

700 1191 Z00

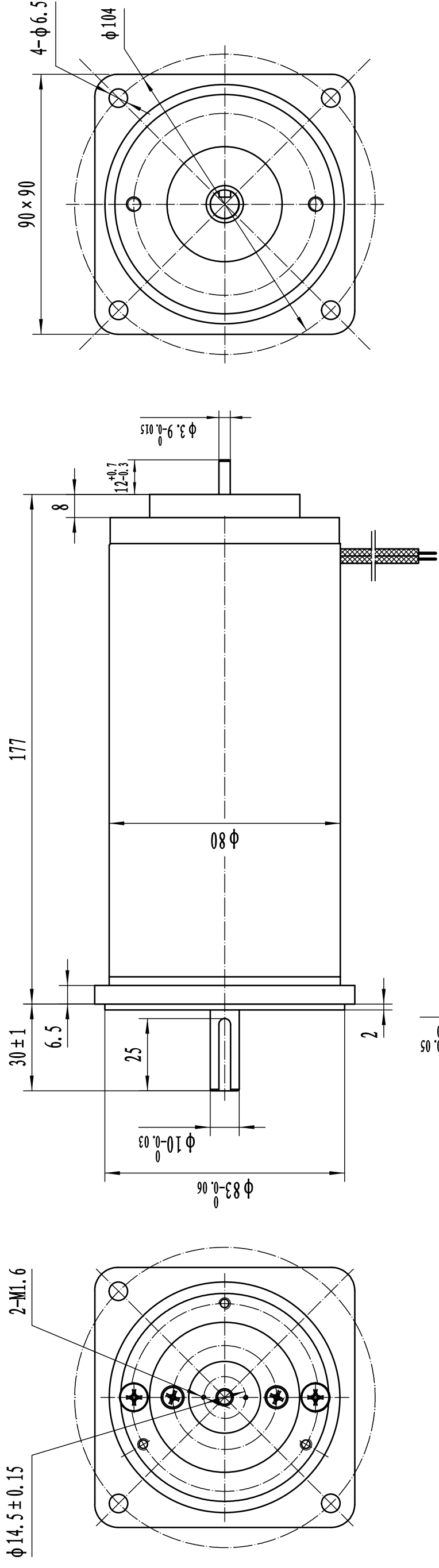

Technical Data

Voltae : 24VDC
 NO Load Speed : 3600 \pm 10%r/min
 Rated Speed : 3000 \pm 10%r/min
 Rated Torque : 0.95 N.m
 Rated Current : \leq 18A
 Duty cycle : S2 30Mins

REV.		QTY.	No.	SIG.	DATE
DESIGN		许卫刚	2018.01.18	STD.	
CHECK					
PROC.				APPR.	
C/S. MAX		QTY	SCALE		
S			1:1		
PAGE	1	OF	1		
DONGZHENG MOTOR			外形图		
80Z170-2436G1030-B					
P/N.		REV			
1:1		0DZ.1617.002			